

NOTES:...

- NO EXCAVATION WORK SHALL COMMENCE UNTIL THE CONTRACTOR HAS CONSULTED UP-TO-DATE SERVICES DRAWINGS AND CARRIED OUT AN ELECTROMAGNETIC LOCATOR (EML) SCAN.
- HAND DIG ONLY WITHIN 500 mm OF EXISTING SERVICES.
- THE CONTRACTOR IS RESPONSIBLE FOR THE DESIGN AND CONSTRUCTION OF ALL TEMPORARY WORKS. THE CONTRACTOR SHALL APPOINT A COMPETENT TEMPORARY WORKS DESIGNER, AND SUBMIT TEMPORARY WORKS DESIGN TO PSDP FOR REVIEW.
- FOR TYPICAL TRENCH CROSS SECTION REFER TO DRAWING No. PE605-D027-083-001
- 225 mm MINIMUM CBGM B OVER DUCTS WHERE THEY TRANSITION FROM STANDARD CROSS SECTION TO FLAT FORMATION.
- WHERE DUCT FOR EARTH CONTINUITY CONDUCTOR (ECC) IS REQUIRED, ATTACH THE 63 mm DUCT TO DUCT A1.
- CONTRACTOR SHALL RECORD DETAILED AS-BUILT INFORMATION AS PER THE SPECIFICATION. AT ALL CROSSING LOCATIONS THESE RECORDS SHALL INCLUDE PHOTOGRAPHIC EVIDENCE CLEARLY DEMONSTRATING THAT MINIMUM SERVICE CLEARANCES AND DUCT SEPARATIONS HAVE BEEN ACHIEVED.
- FOR RIVER / STREAM CROSSINGS, THE DUCTS LAYOUT AND CROSSING DETAILS ARE THE SAME TO THE DRAINAGE DITCH CROSSING.
- SEPARATION BETWEEN POWER CABLE DUCTS TO BE DETERMINED BY CABLE RATING CALCULATIONS BASED ON THE MAXIMUM DEPTH OF COVER TO THE DUCTS.

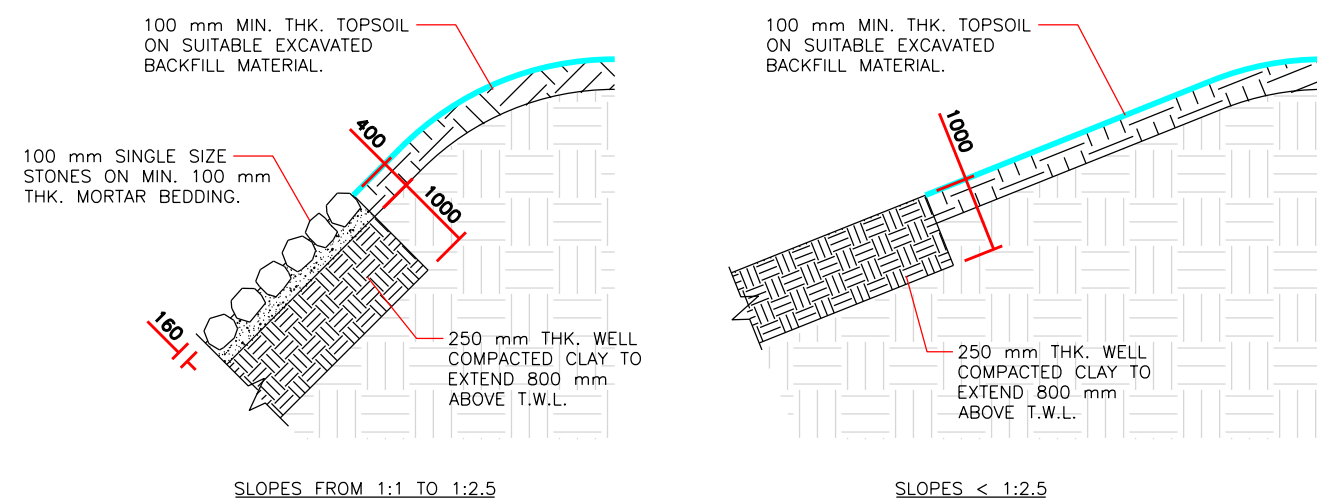

**Bank Details**  
Scale 1:20

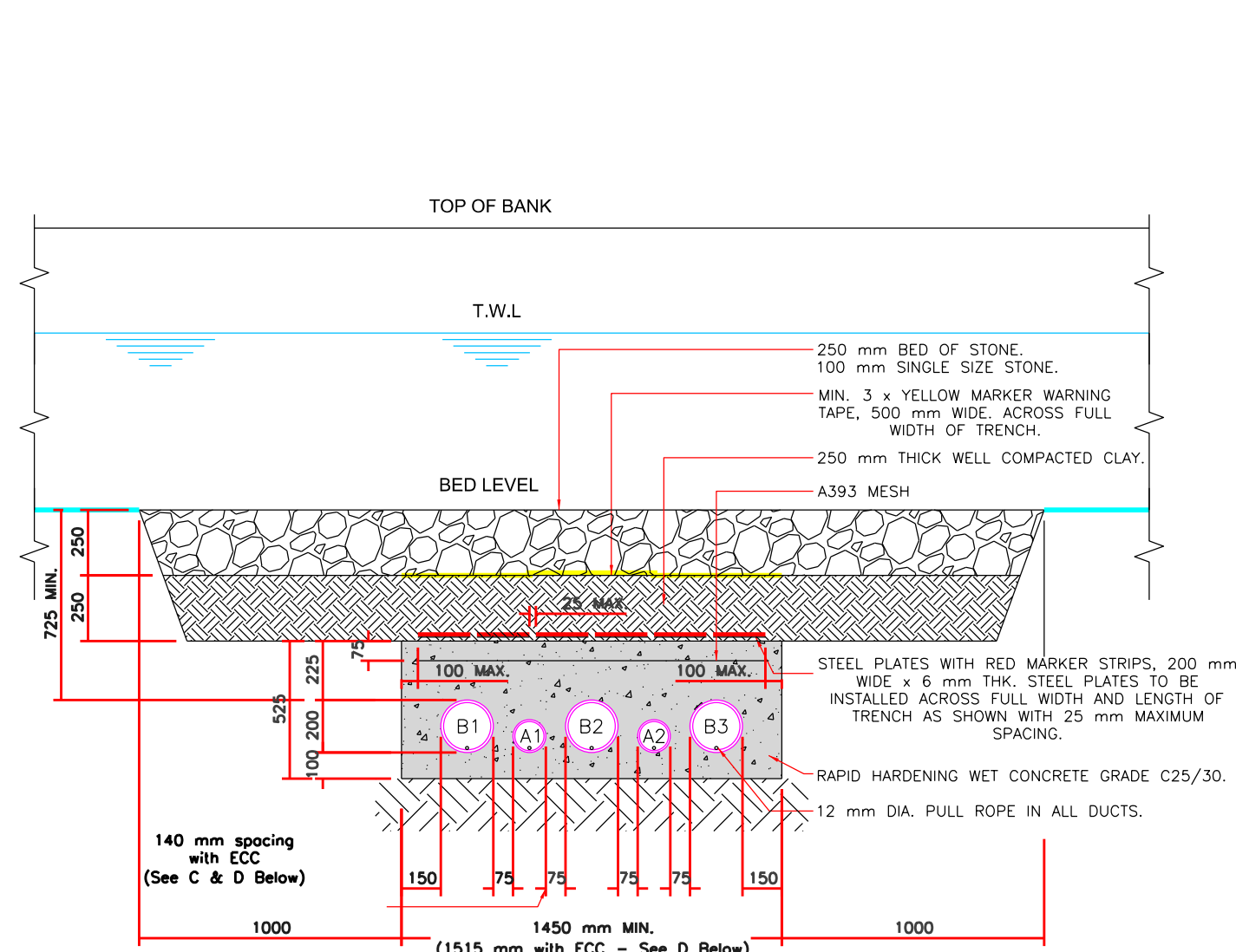

- A = 125 mm OUTER DIAMETER HDPE EirGrid APPROVED DUCT, SDR = 17.6
- B = 200 mm OUTER DIAMETER HDPE EirGrid APPROVED DUCT, SDR = 21
- C = MIN. 75 mm DUCT SPACING TO BE CONFIRMED BY CABLE RATINGS CALCULATIONS, REFER TO NOTE 9.
- D = MIN. 140 mm DUCT SPACING, REFER TO NOTE 6.

**Trench Cross Section**  
Scale 1:25

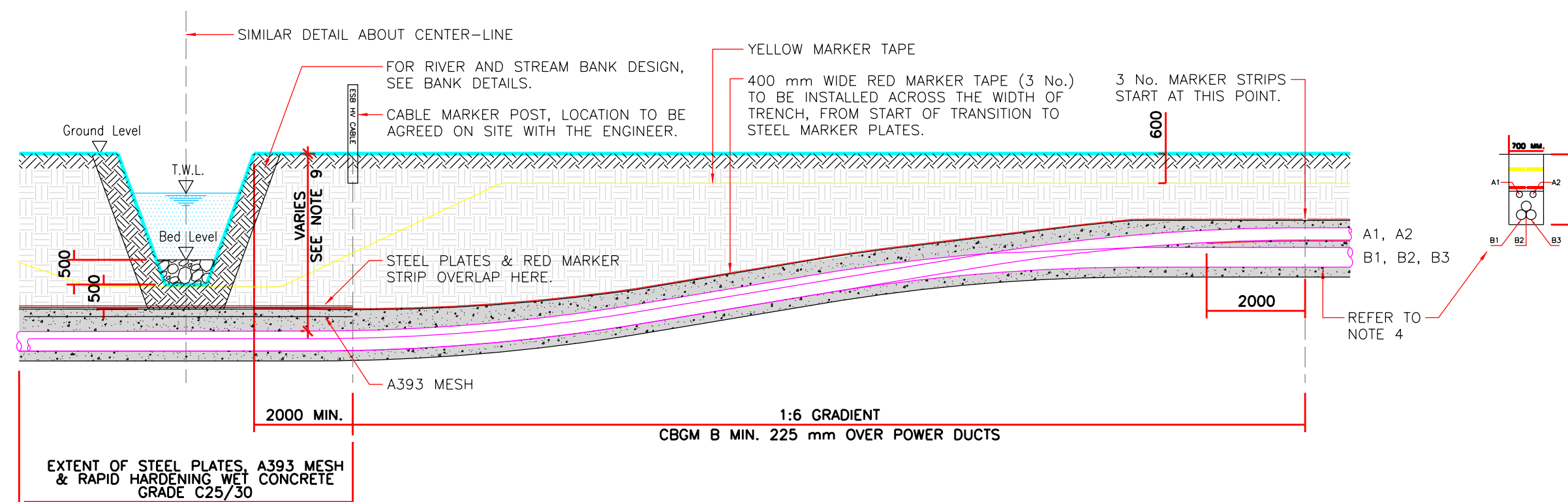

**Longitudinal Section - (Crossing Under Culvert/Service)**  
Scale 1:25

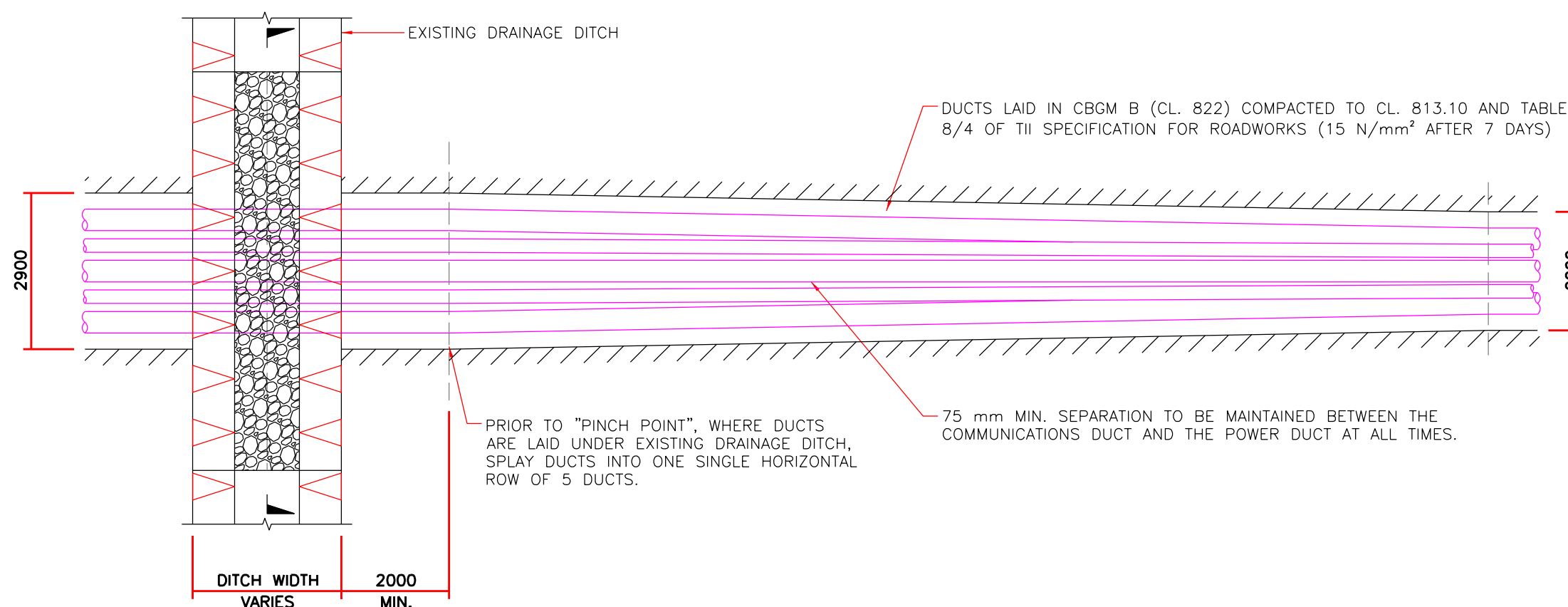

**Plan View**  
Scale 1:25

Rev.	Date	Description	Drn.	Prod.	Ver.	App.
06		UPDATED CROSS SECTION SCALE TO 1:25				
05	06/02/24	REPLACED 'TYPICAL' WITH 'GENERAL ARRANGEMENT' IN TITLE BLOCK	NB	NB	RD	MH
04	22/12/23	UPDATED TITLE BLOCK SCALE TO AS STATED	NB	NB	RD	RD
03	14/08/2023	UPDATED PROJECT NAME TO ORIEL WIND FARM PROJECT	NB	NB	RD	RD
02	19/05/2023	UPDATED TRENCH TO 700 MM TO MATCH EIRGRID SPEC	CB	CB	RD	RD

Purpose of issue - Preliminary unless indicated  
 Client Approval  Planning  Tender  Construction  As-built

**ESB** Engineering and Major Projects,  
 One Dublin Airport Central,  
 Dublin Airport, Cloughran,  
 Co. Dublin, K67 XF72, Ireland.  
 Tel: +353 (0)1 703 8000 Web: www.esb.ie  
 Engineering and Major Projects is a division of ESB.

Client	ORIEL WINDFARM LIMITED
Project	ORIEL WIND FARM PROJECT
Contract	

Production Unit	Civil, Environmental and Renewable Engineering
Drawing Title	TRENCH CROSS SECTION 220 KV CABLE GENERAL ARRANGEMENT 700 mm WIDE TRENCH FOR DRAINAGE, DITCH AND STREAM CROSSING

COPYRIGHT © ESB All rights reserved. No part of this work may be modified, reproduced or copied in any form or by any means - graphic, electronic or mechanical, including photocopying, recording, taping or used for any purpose other than its designated purpose, without the written permission of ESB.				
DRAWN	PRODUCED	VERIFIED	APPROVED	APPROVAL DATE
Begley_G	N.Bell	R.Doyle	M.Hogan	15/02/2024
CLIENT REF	No. OF SHITS	SIZE	SCALE	
TC226637	1/1	A2	AS STATED	
Drawing Number	SHEET REV			
	PE605-D027-087-001-006			